

NOTE! Read the *Installation Manual D4/D6 Aquamatic DPH/DPR, Volvo Penta IPS, Inboard* before the installation work of IPS propulsion unit and engine is started. Other electrical installations, please refer to *Installation Manual EVC^{cc}-C2, Electronic Vessel Control Volvo Penta IPS*.

Installation Reference, Volvo Penta IPS Propulsion Unit and Engine

WARNING! Make sure all safety precautions are made prior to lifting to avoid personal injuries and damage on equipment.
NOTE! Before installing propulsion unit and engine, make sure that the rest of the installation work in the engine compartment has been completed. In addition, all cables and hoses must be correctly located and clamped.

1 Installation kit

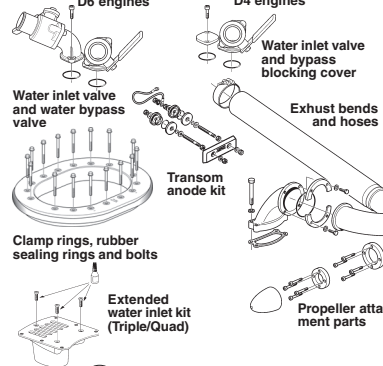

2 Chassis no. identification

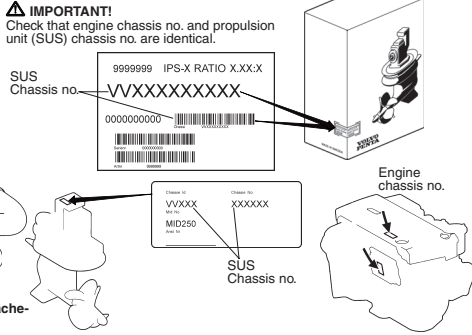

3-6 Installing the propulsion unit

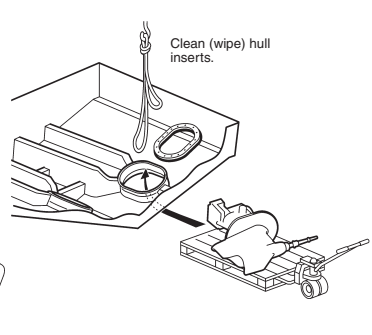

4

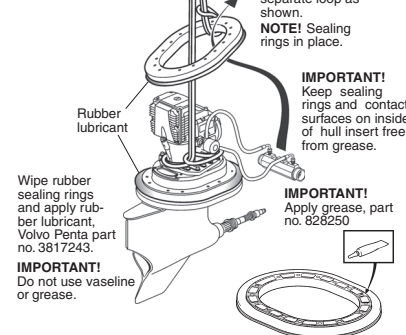

5

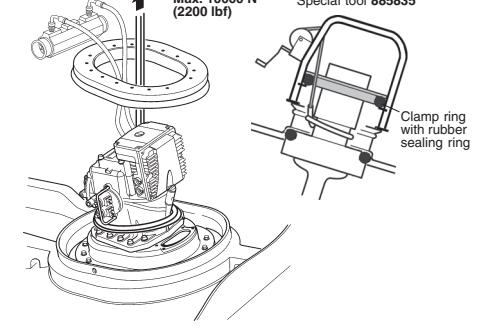

6

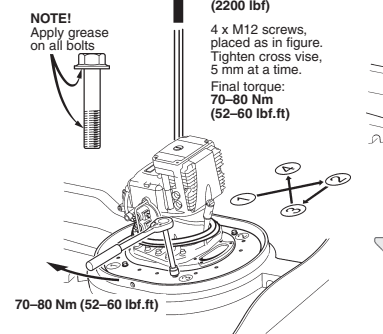

7 Installing the water inlet and water bypass valves

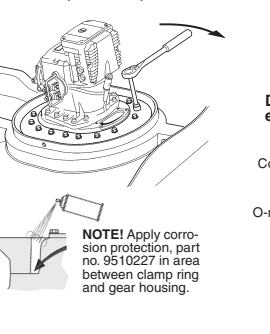

8 Installing the engine

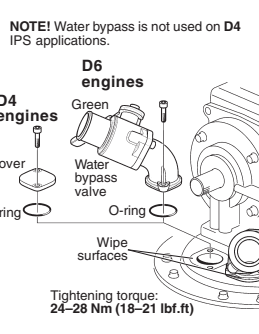

9 Connecting the drive shaft

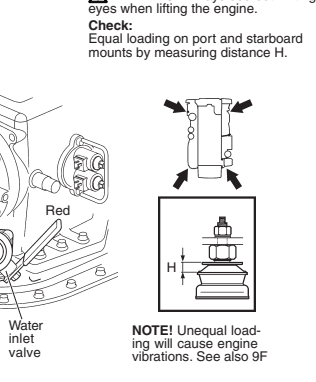

10 Installing the oil cooler

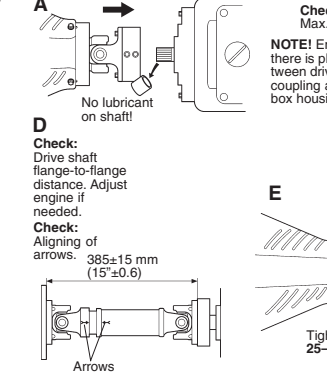

11 Mounting the protective anode. Installing the exhaust line and the water inlet and bypass hoses

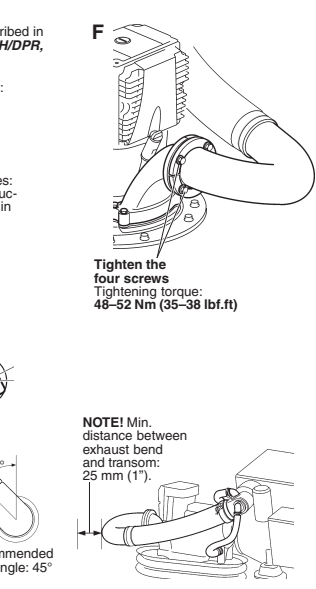
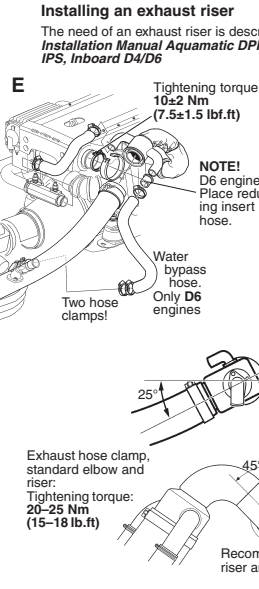
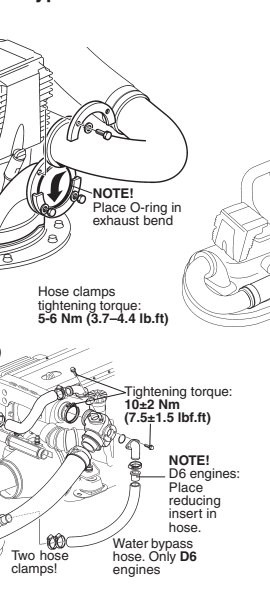
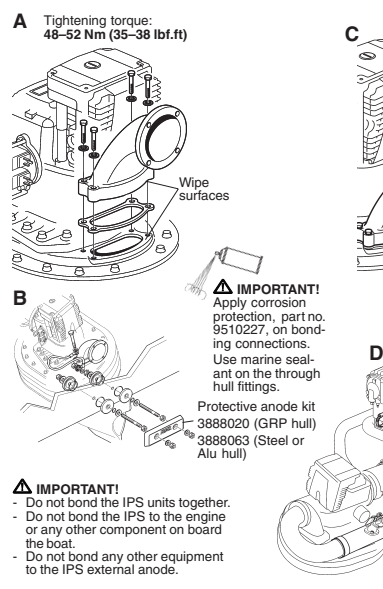

12 Power supply

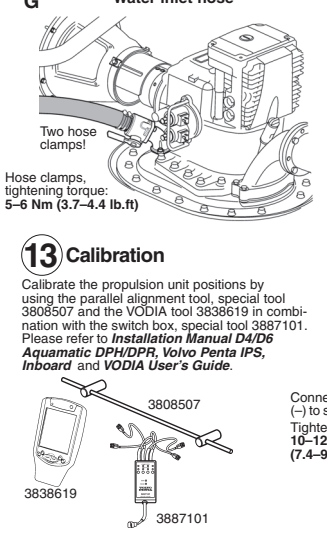

13 Calibration

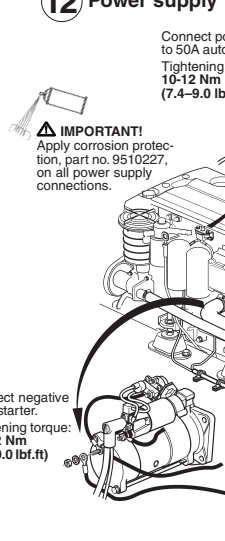

NOTE! Read the *Installation Manual D4/D6 Aquamatic DPH/DPR, Volvo Penta IPS, Inboard* before the installation work of IPS propulsion unit and engine is started. Other electrical installations, please refer to *Installation Manual EVC^{cc}-C, Electronic Vessel Control Volvo Penta IPS*.

Installation Reference, Volvo Penta IPS Jack shaft mounting

WARNING! Make sure all safety precautions are made prior to lifting to avoid personal injuries and damage on equipment.
NOTE! Before installing propulsion unit and engine, make sure that the rest of the installation work in the engine compartment has been completed. In addition, all cables and hoses must be correctly located and clamped.

1 Jack shaft installation kits

Designation	Qty.	Ref.
A. Drive shaft		
Jack shaft, ordered length	1	(Step 3)
B. Jack shaft kit		
M14x50 flange screw	8	
Protective casing, compl.	1	(Step 4)
M10x35 flange screw	10	
Shaft coupling	1	(Step 5)
C. Catch kit		
Front end catch, complete	1	(Step 6)
M10x30 flange screw	4	
Rear end catch, complete	1	(Step 7)
M10x30 flange screw	4	
M10 flange nut	5	
M8x20 flange screw	3	
D. Cables		
Extension cable, 6-pin	1	
T-connector	1	
Power supply cables (+/-)	1	
E. Oil distribution kit		
Hose unit	1	(Step 9)
O-ring	1	
Oil filter	1	
Gear box oil can, 1 lit.	1	
F. Exhaust kit D4 engines		
Exhaust riser kit	1	(Step 10)
Exhaust kits D6 engines		
Exhaust elbow kit	1	(Step 10)
Exhaust riser kit	1	(Step 10)
Rubber insert, water by-pass hose, Ø 50-45 mm (2"-1 3/4")	1	
G. Hoses and hose connection kit		
Hose clamp, Ø 140 mm	1	(Step 11)
Hose clamp, Ø 66 mm	1	
Exhaust hose Ø 5" (127 mm), incl. bend	1	(Step 11)
Water inlet hose Ø 2" (50 mm)	1	(Step 12)
D4 engines: Rubber insert, water inlet, Ø 50-38 mm (2"-1 1/2")	1	(Step 12)
D6 engines: Water by-pass hose, Ø 2" (50 mm)	1	(Step 12)

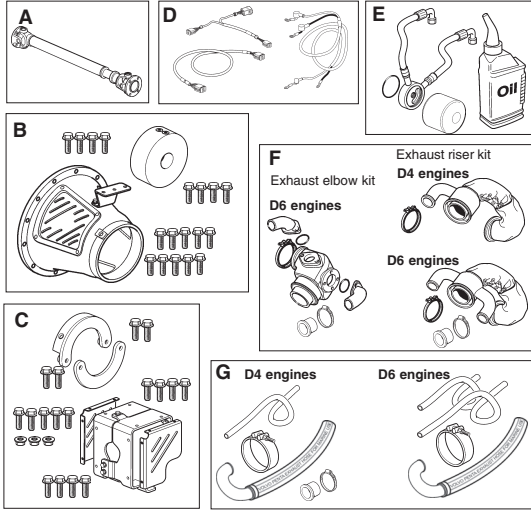

2 IPS Hull and Engine foundation

Please refer to poster *Installation Reference, Volvo Penta IPS Hull & Engine foundation* Publ. No. 7747482.

IMPORTANT! Check that engine chassis no. and propulsion unit chassis no. are identical.

3 Connecting the drive shaft, front end (engine side)

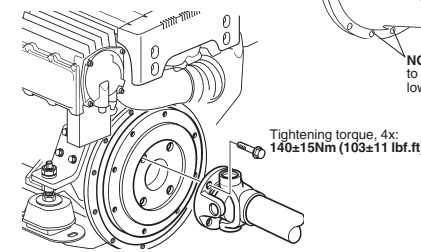

4 Mounting the front end protective casing

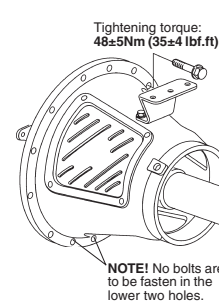

5 Connecting the drive shaft, rear end (propulsion unit)

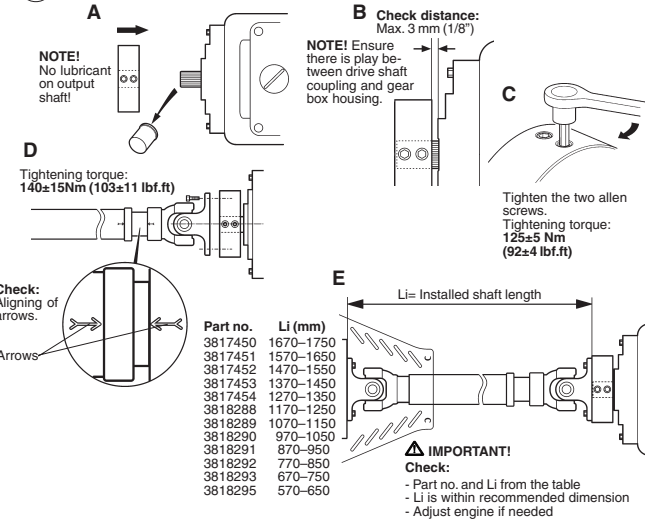

6 Mounting the front end catch

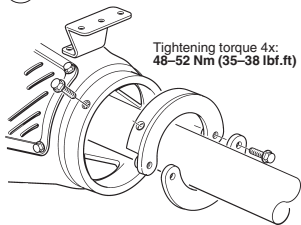

7 Mounting the rear end catch (D6 installation is shown)

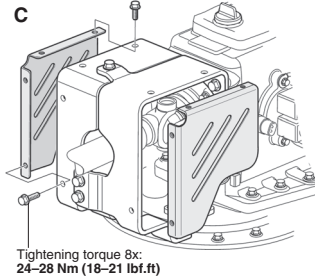
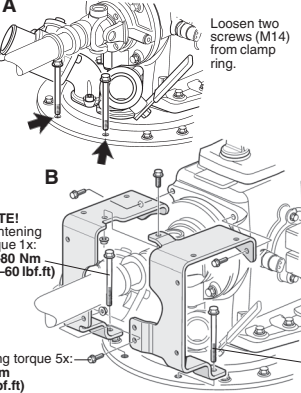

8 Installing the oil cooler

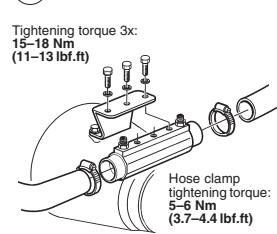

9 Installing new oil hoses to gear box and oil cooler

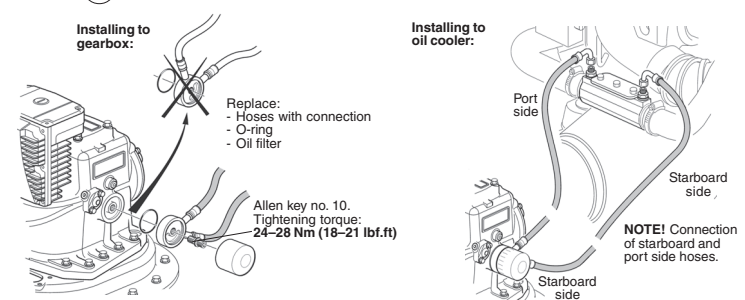

10 Installing exhaust elbow and exhaust riser

Installing an exhaust elbow
Only on D6 engines.

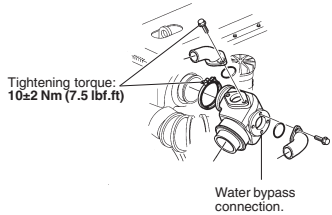

Installing an exhaust riser
The need of an exhaust riser is described in *Installation Manual D4/D6 Aquamatic DPH/DPR, Volvo Penta IPS, Inboard*

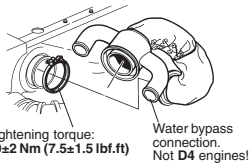

Elbow and riser

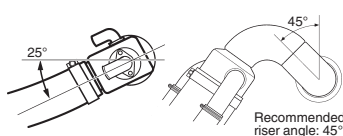
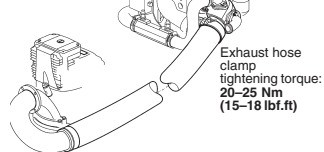

12 Installing: Water inlet hose and water bypass hose

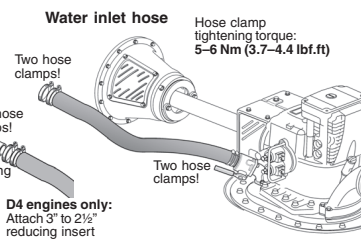
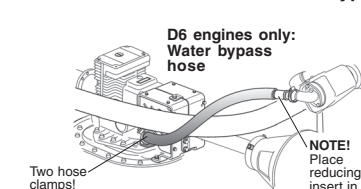

13 Connecting: Shift cables, steering cables and power supply cables to the SUS

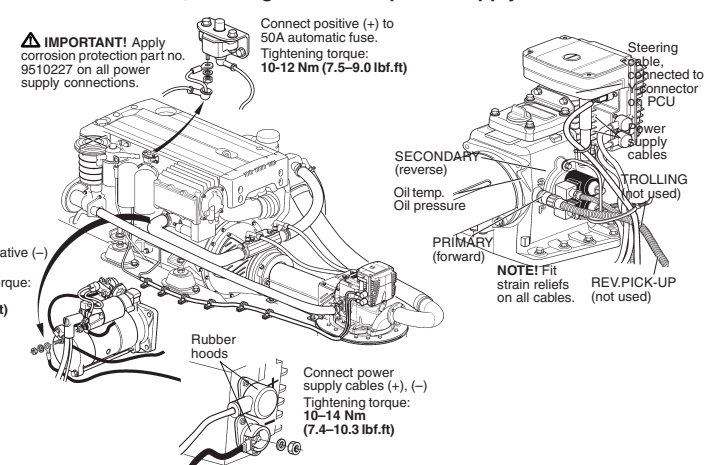

14 Calibration

Please refer to *Installation Manual D4/D6 Aquamatic DPH/DPR, Volvo Penta IPS, Inboard and VODIA User's Guide*.